

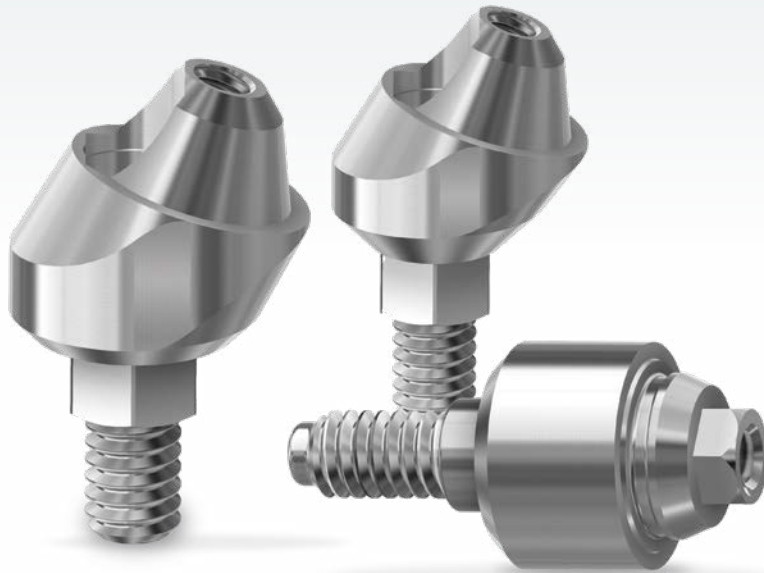

A complete solution for
screw-retained restorations



Universal Multi-Unit Abutments

for TSV®, TSX™, and
Eztetic® Implant
Connections

One 4.8 mm Restorative Platform

Includes a new digital workflow for greater flexibility
in your definitive restoration

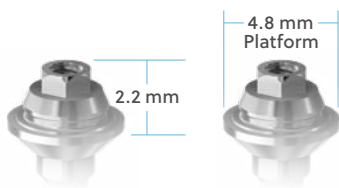

Low 2.2 mm restorative height
for limited interarch spaces



Universal TiBases are available
in multiple heights for more
versatility and for angulated
screw channel access



Universal Implant Analogs can be used
in both stone or 3D models





Universal Straight Abutment

Non-engaging, does not engage in the internal hex connection. Not for use in single unit restorations.

	Eztetic®	TSV® and TSX™ Implant Systems		
Collar Height	Ø2.9 mm	Ø3.5 mm	Ø4.5 mm	Ø5.7 mm
1.0 mm	UMUA-NP291S	UMUA-TSV351S	UMUA-TSV451S	UMUA-TSV571S
2.0 mm	UMUA-NP292S	UMUA-TSV352S	UMUA-TSV452S	UMUA-TSV572S
3.0 mm	UMUA-NP293S	UMUA-TSV353S	UMUA-TSV453S	UMUA-TSV573S
4.0 mm	UMUA-NP294S	UMUA-TSV354S	UMUA-TSV454S	UMUA-TSV574S
5.0 mm	UMUA-NP295S	UMUA-TSV355S	UMUA-TSV455S	UMUA-TSV575S



Universal Angled Abutment, 17°

Engaging in implant, not for use in single-unit restorations (incl. preassembled retaining screw)

	Eztetic	TSV and TSX Implant Systems		
Collar Height	Ø2.9 mm	Ø3.5 mm	Ø4.5 mm	Ø5.7 mm
2.5 mm	UMUA-NP2925-17S	UMUA-TSV3525-17S	UMUA-TSV4525-17S	UMUA-TSV5725-17S
3.5 mm	UMUA-NP2935-17S	UMUA-TSV3535-17S	UMUA-TSV4535-17S	UMUA-TSV5735-17S



Universal Angled Abutment, 30°

Engaging in implant, not for use in single-unit restorations (incl. preassembled retaining screw)

	Eztetic	TSV and TSX Implant Systems		
Collar Height	Ø2.9 mm	Ø3.5 mm	Ø4.5 mm	Ø5.7 mm
3.5 mm	UMUA-NP2935-30S	UMUA-TSV3535-30S	UMUA-TSV4535-30S	UMUA-TSV5735-30S
4.5 mm	UMUA-NP2945-30S	UMUA-TSV3545-30S	UMUA-TSV4545-30S	UMUA-TSV5745-30S

Universal Components	
Implant Analog	UMUA-A
Implant Analog (0.050" screw hex)	UMUA-DA
Healing Cap (0.050" screw hex)	UMUA-HCS
Temporary Cylinder	UMUA-TCS
Intraoral Scan body	UMUA-SBIO
TiBase Scan body, Qty 5	UMUA-SBTB5
Desktop Scan body (0.050" screw hex)	UMUA-SBDT
Impression Coping	UMUA-OTIC
Impression Coping, 5 mm(H), Qty 1	UMUA-CTICS
Impression Coping, 5 mm(H), Qty 4	UMUA-CTICS4
Impression Coping, 8 mm(H), Qty 1	UMUA-CTICL
Impression Coping, 8 mm(H), Qty 4	UMUA-CTICL4
Multi-unit TiBase, 6 mm(H) (0.050" screw hex)	UMUA-TTS
Multi-unit TiBase, 8 mm(H) (0.050" screw hex)	UMUA-TTL
Angulated Screw Channel TiBase	UMUA-ASCT
Angulated Screw Channel TiBase Screw	UMUA-ASCTS
Multi-unit Screw (0.050" screw hex)	UMUA-S
OverdenSURE® Attachment	UMUA-ODS

Universal Tools	
Multi-unit Driver	UMUA-D
Angulated Screw Channel Screwdriver, 24 mm(L)	ASC-SD24
Angulated Screw Channel Screwdriver, 30 mm(L)	ASC-SD30
ISO Latch, 4x4 Driver	ISO4X4A

For more information, visit ZimVie.com

ZimVie
4555 Riverside Drive
Palm Beach Gardens, FL 33410
Tel: +1-561-776-6700
Fax: +1-561-776-1272

 **ZimVie**
Restoring Daily Life.®

Unless otherwise indicated, as referenced herein, all trademarks are the property of ZimVie; and all products are manufactured by one or more of the dental subsidiaries of ZimVie Inc. (Biomet 3i, LLC, Zimmer Dental Inc., etc.) and marketed and distributed by ZimVie Dental (formerly Zimmer Biomet Dental) and its authorized marketing partners. Universal Multi-unit abutments, components and tools are manufactured by Terrats Medical. Product clearance and availability may be limited to certain countries/regions. This material is intended for clinicians use only and does not comprise medical advice or recommendations. Distribution to any other recipient is prohibited. This material may not be copied or reprinted without the express written consent of ZimVie. ZV0655 REV A 04/23 ©2023 ZimVie. All rights reserved.

